

# WORKTOP FREEZER

## VWF67HC

PROJECT: \_\_\_\_\_

ITEM # \_\_\_\_\_ QTY: \_\_\_\_\_

MODEL # \_\_\_\_\_

AIA # \_\_\_\_\_ SIS # \_\_\_\_\_



## CABINET CONSTRUCTION

- Stainless Steel Exterior (galvanized back & bottom)
- Aluminum Interior
- 4" High, Foamed-In-Place Backsplash
- One Piece, Snap-In Magnetic Door Gaskets
- 6" Casters
- 8' Cord And Plug (see electrical data for details)

## FEATURES

- Full Electronic Control
- Stay-Open Door Feature For Easy Product Loading
- Heavy-Duty Spring-Loaded Cartridge Hinges
- Low Profile Horizontal Door Handles
- Epoxy Coated Shelves (2 per section)

## REFRIGERATION

- Refrigeration System Uses R-290 Refrigerant To Comply With All Environmental Concerns
- Side Mounted Refrigeration System
- Adaptive Defrost For Reduced Energy Consumption And More Consistent Product Temperatures
- Epoxy Coated Evaporator Coil
- Freezer Capable Of Maintaining Product Temperature -10°F

- ▶ **3 Year Parts & Labor Warranty**
- ▶ **Plus An Additional 4 Year Compressor Warranty**
- ▶ **Exclusive 2 Year Warranty On Magnetic Door Gaskets**
- ▶ **Lifetime Warranty On Handles & Hinges (parts only)**



Please verify qualifying units by visiting:  
[www.energystar.gov/cfs](http://www.energystar.gov/cfs)

## OPTIONS & ACCESSORIES

- |  |   |  |
|--|---|--|
| <ul style="list-style-type: none"> <li>• Stainless Steel Interior</li> <li>• Stainless Steel Back</li> <li>• Secure-Temp™ Technology</li> <li>• Door Locks</li> <li>• Door Swing Orientation (at time of order)</li> </ul> | <ul style="list-style-type: none"> <li>• Cutting Board</li> <li>• Additional Shelves</li> <li>• Shelf Clips (set of 4)</li> <li>• 6" Legs or 6" Seismic Legs</li> <li>• Casters: 3", Roller Kit, Low Profile</li> </ul> | <ul style="list-style-type: none"> <li>• Correctional Package</li> <li>• Remote Models* (6" legs only)<br/>(refrigerant must be specified at time of order, see note on back on page)</li> </ul> |
|--|---|--|

3779 Champion Blvd, Winston-Salem, NC 27105

ph: (888) 845-9800 | fax: (800) 253-5168

Sales@VictoryRefrigeration.com | VictoryRefrigeration.com

Rev. 10/29/21 Printed in U.S.A.

APPROVAL: \_\_\_\_\_ DATE: \_\_\_\_\_

## WORKTOP FREEZER

# VICTORY<sup>®</sup> WORKTOP FREEZER

## VWF67HC

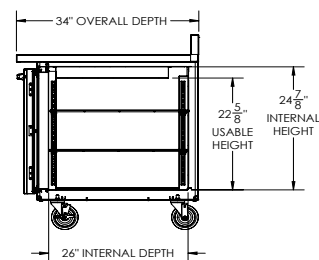
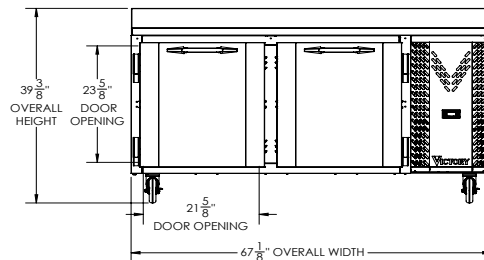
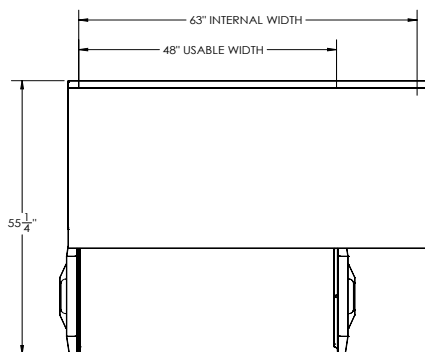

We reserve the right to change specifications and product design without notice. Such revisions do not entitle the buyer to corresponding changes, improvements, additions or replacements for previously purchased equipment. Dimensional tolerances +/- 1/4". Metric dimensions (MM)

CHARACTERISTICS		ELECTRICAL DATA		SHIPPING DETAILS	
Net Capacity (cubic ft.)	20.08	Cabinet Voltage	115/60/1	Height	49"
Width, Overall (in.)	67 1/8"	Total Amperes	9.0	Width	70"
Depth, Overall (with handle)	34"	NEMA Plug (8' cord)	5-15P	Depth	37"
Height Overall (6" casters)	39 3/8"	REFRIGERATION DATA		Crated Weight	460 lbs
Depth, Door Open 90°	55 1/4"	Condensing Unit Size, HP	3/4	*NOTE: Remote units are field wired and comes with 6" legs. Refrigerant must be specified at time of order.	
Door Opening (in.)	21 5/8" x 23 5/8"	Refrigerant*	R-290		
No. Of Doors/Shelves	2/4	Capacity (BTU/HR) (100°F/20°F)	2312		
		Heat Rejection (BTU/HR)	3468		
		Charge (lbs/grams)	0.1653/75		

3779 Champion Blvd, Winston-Salem, NC 27105 | ph: (888) 845-9800 | fax: (800) 253-5168

Sales@VictoryRefrigeration.com | VictoryRefrigeration.com

Rev. 10/29/21 Printed in U.S.A.

an Ali Group Company



The Spirit of Excellence