



ITEM #: _____ QTY: _____
 MODEL #: _____
 PROJECT NAME: _____

060320

3601 S. Banker St. Effingham, IL 62401 • P.O. BOX 609 • Ph: (888) 431-2667 • Fax: (800) 433-2667

"TCH" STORAGE CABINET

FEATURES:

- 18-GAUGE STAINLESS STEEL
- TYPE 400 SERIES STAINLESS STEEL
- 4 ADJUSTABLE STAINLESS-STEEL SHELVES
- SLOPED TOP
- ADJUSTABLE BULLET FEET
- MOUNTING HOLES IN BACK PANEL TO SECURELY FASTEN TO WALL

MATERIAL:

- BODY: 18-GAUGE TYPE 400 SERIES STAINLESS STEEL
- SHELVES: 18-GAUGE TYPE 400 SERIES STAINLESS STEEL

CONSTRUCTION:

- STAINLESS STEEL CABINETS ARE TIG WELDED, EXPOSED WELDS ARE POLISHED TO MATCH ADJECTED SURFACE #4 POLISH, SATIN FINISH



STORAGE CABINET

MODEL	QTY
TCH-223684	
TCH-224884	

DETAILED SPECIFICATIONS

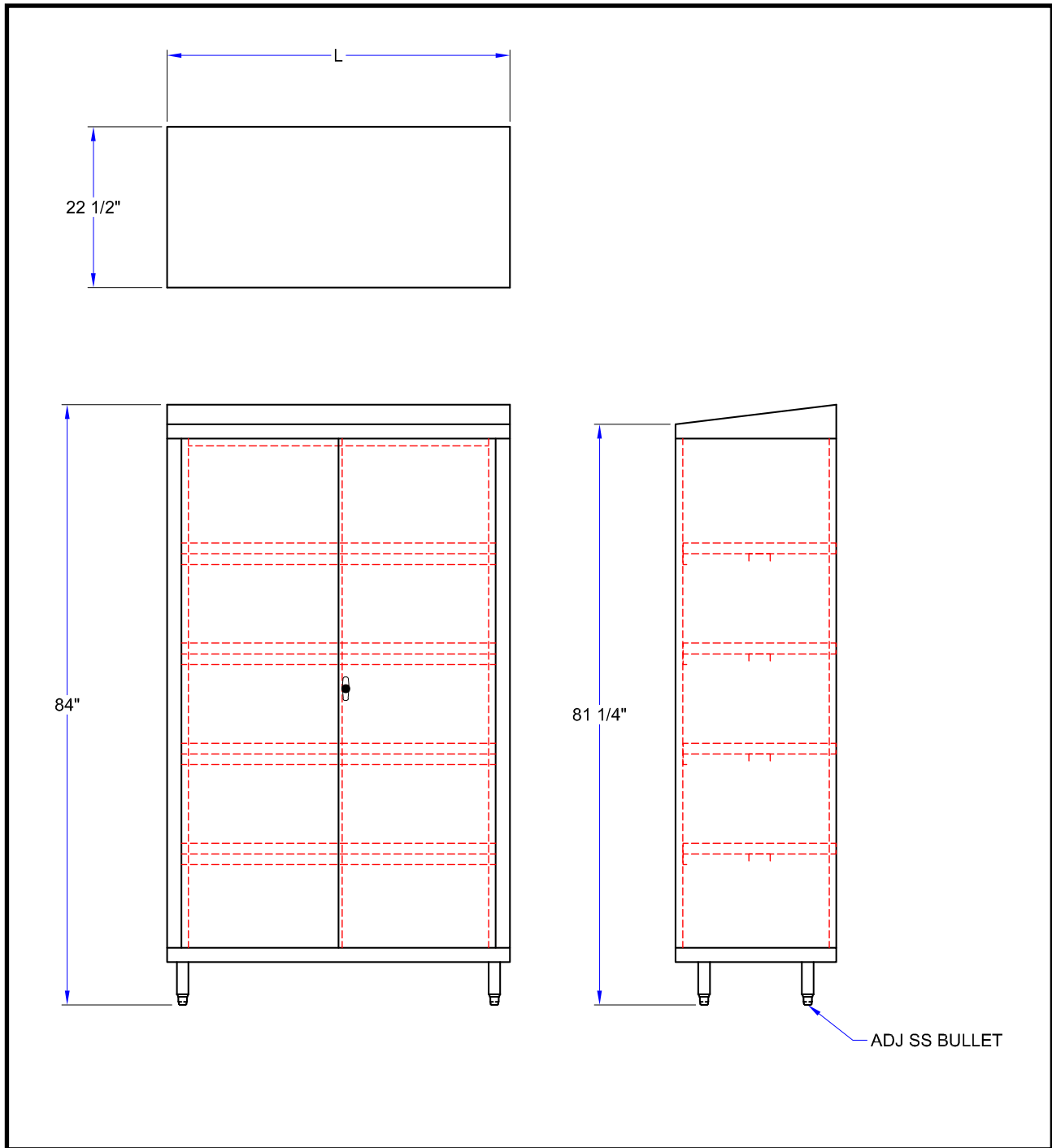

STORAGE CABINET

MODEL	OVERALL SIZE (LxWxH)	WEIGHT (LBS)
TCH-223684	36" X 22-1/2" X 84"	270
TCH-224884	48" X 22-1/2" X 84"	337

SOME UNITS SHIP UNASSEMBLED FOR REDUCED SHIPPING COST. ALL DIMENSIONS ARE TYPICAL. TOLERANCE +/- .500"
 John Boos & Co. is constantly engaged in a program of improving products and therefore reserves the right to change specifications without prior notice.



Boos
lock

AQ AutoQuotes

3601 S. Banker St. • Effingham, IL 62401 • PO BOX 609 • quotes@johnboos.com

www.johnboos.com

060320

626