



Model: _____ Item #: _____ Date: _____

Project: _____ Qty: _____ Approved By: _____

Royal Series Full Sliding Covers for Ice Bins

Royal Series Underbar



SC30F

Standard Features

- Fits all Krowne Ice Bins, Workstations, and Multi-Stations
- Fits both Royal Series and Silver Series Underbar
- Used when ice bin is not using bottle wells



◀ Full Sliding Covers are made for ice bins that do not use bottle wells. The cover fully covers the ice bin.

Specifications

Material ▪ 20 gauge stainless steel



For 19" Depth Ice Bins (KR19 Series)

Model	Depth of Ice Bin	Length of Sliding Cover (A)	Depth of Sliding Cover when opened
SC12F	19"	12"	8-3/4"
SC18F	19"	18"	8-3/4"
SC24F	19"	24"	8-3/4"
SC30F	19"	30"	8-3/4"
SC36F	19"	36"	8-3/4"
SC42F	19"	42"	8-3/4"
SC48F	19"	48"	8-3/4"

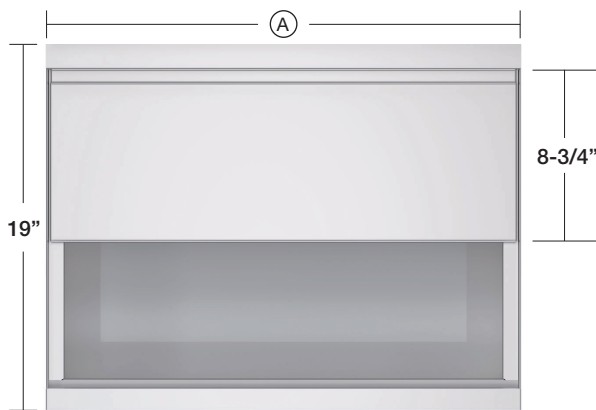

TOP VIEW OF KR19 ICE BIN WITH FULL SLIDING COVER OPEN

For 24" Depth Ice Bins (KR24 Series)

Model	Depth of Ice Bin	Length of Sliding Cover (A)	Depth of Sliding Cover when opened
SCD12F	24"	12"	11-1/4"
SCD18F	24"	18"	11-1/4"
SCD24F	24"	24"	11-1/4"
SCD30F	24"	30"	11-1/4"
SCD36F	24"	36"	11-1/4"
SCD42F	24"	42"	11-1/4"
SCD48F	24"	48"	11-1/4"

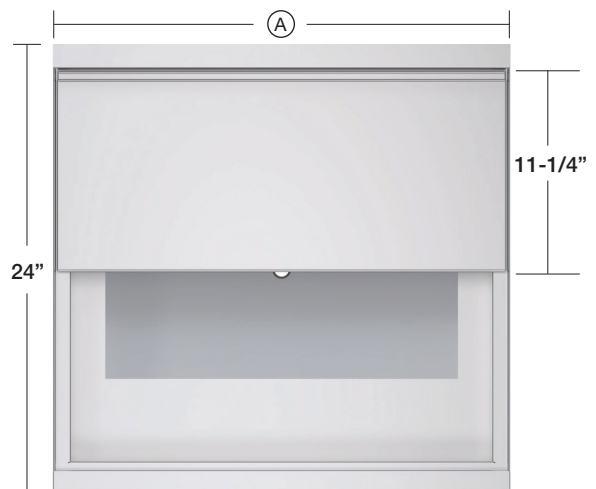

TOP VIEW OF KR24 ICE BIN WITH FULL SLIDING COVER OPEN