



**John
BOOS**
Since 1887

ITEM #: _____ QTY: _____

MODEL #: _____

PROJECT NAME: _____

082120

3601 S. Banker St. Effingham, IL 62401 • P.O. BOX 609 • Ph: (888) 431-2667 • Fax: (800) 433-2667

"PBJC-48" DELUXE JANITOR CABINET WITH MOP SINK



FEATURES:

- TYPE 300 STAINLESS STEEL WITH #4 POLISH SATIN FINISH
- ALL EXPOSED HARDWARE IS TAMPER PROOF
- (2) SWING LOCKABLE LOUVERED DOORS
- AVAILABLE IN LEFT SIDE OR RIGHT SIDE CONFIGURATION
- INCLUDES (1) HEAVY DUTY SERVICE FAUCET (PBF-SS-6)
- INCLUDES (1) 10" SERVICE FAUCET HOSE (PB-HOSE-120)
- MOP SINK COMPARTMENT SIDE INCLUDES
 - (1) OVERSIZED MOP SINK 20" X 16" X 12"
 - (1) OVERHEAD STORAGE SHELF
 - (2) SHELF MOUNTED MOP HOLDERS WITH LOCKING CAMS
 - PANEL LESS BACK
- STORAGE COMPARTMENT SIDE INCLUDES
 - (3) STORAGE SHELVES
 - BOTTOM STORAGE AREA

CONSTRUCTION:

- CABINET: STAINLESS STEEL CABINETS TIG WELDED, EXPOSED EDGES ARE POLISHED TO MATCH ADJACENT SURFACE

MATERIAL:

- CABINET: 18GA TYPE 300 STAINLESS STEEL WITH #4 POLISH, SATIN FINISH
- 18 GAUGE TYPE 300 CABINET
- 16 GAUGE TYPE 300 SINK BOWL AND DECK



PBJC-224884-L



DELUXE JANITOR CABINET WITH MOP SINK

MODEL	QTY
PBJC-224884-L	
PBJC-224884-R	



PBF-SS-6



PB-HOSE-120

DETAILED SPECIFICATIONS

PBJC-224884-L

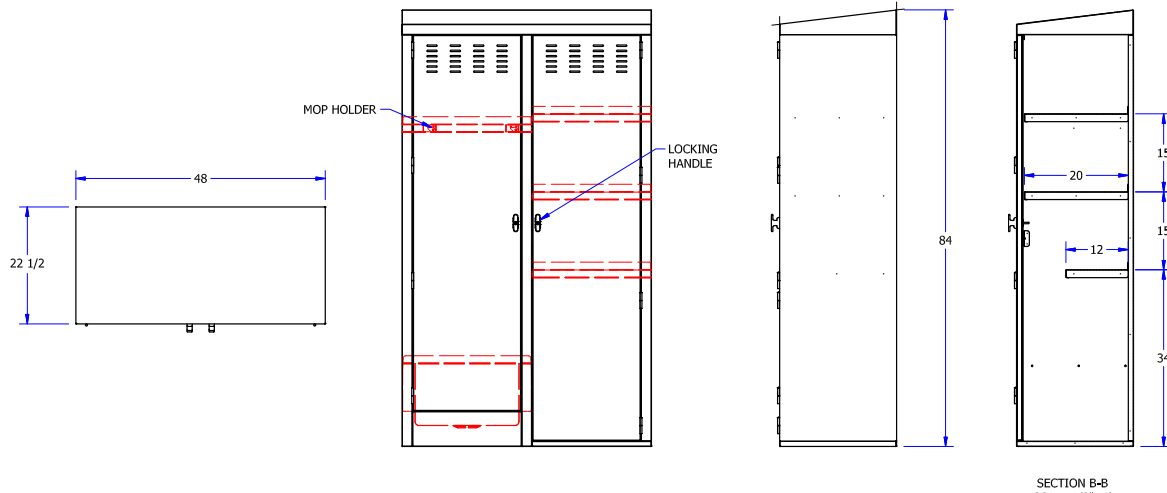

PBJC-224884-R

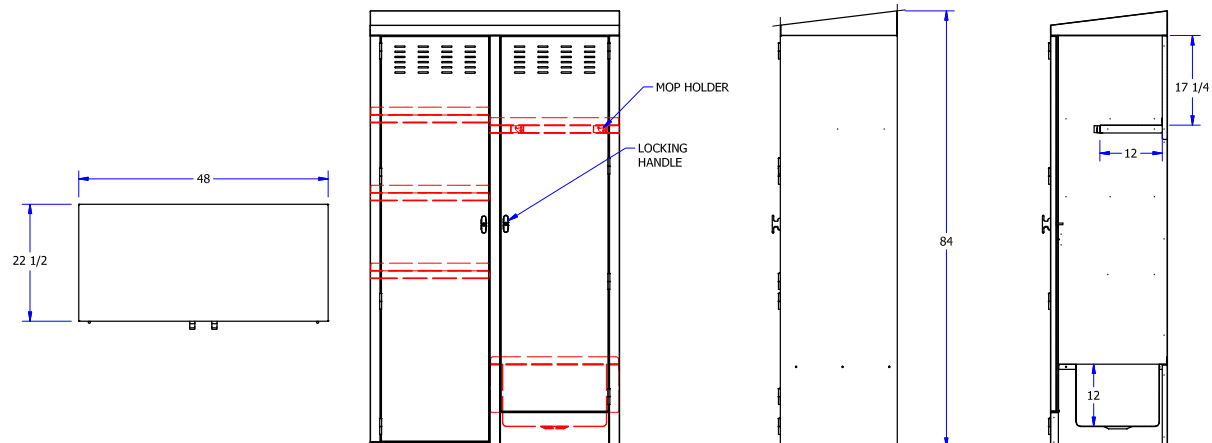

DELUXE JANITOR CABINET WITH MOP SINK

MODEL	OVERALL SIZE (LxWxH)	MOP SINK SIZE (LxWxD)	MOP SINK LOCATION	WEIGHT (LBS)
PBJC-224884-L	48" X 22-1/2" X 84"	20" X 16" X 12"	LEFT	292
PBJC-224884-R	48" X 22-1/2" X 84"	20" X 16" X 12"	RIGHT	292

SOME UNITS SHIP UNASSEMBLED FOR REDUCED SHIPPING COST. ALL DIMENSIONS ARE TYPICAL. TOLERANCE +/- .500"
 John Boos & Co. is constantly engaged in a program of improving products and therefore reserves the right to change specifications without prior notice.



Boos
lock

AQ AutoQuotes

3601 S. Banker St. • Effingham, IL 62401 • PO BOX 609 • quotes@johnboos.com

www.johnboos.com

082120

609