

ITEM #: _____	QTY: _____
MODEL #: _____	
PROJECT NAME: _____	

112117

3601 S. Banker St. Effingham, IL 62401 • P.O. BOX 609 • Ph: (888) 431-2667 • Fax: (800) 433-2667

"EBHS6 ENCLOSED BASE TABLES 16GA **STAINLESS TOP - HINGED**



FEATURES:

- 16 GAUGE STAINLESS STEEL FLAT TOP
- HINGED DOOR STYLE
- TYPE 300 STAINLESS STEEL WITH #4 POLISH, SATIN FINISH
- TOP IS SOUND DEADENED
- REINFORCED WITH 1"X2" CHANNEL RUNNING ENTIRE LENGTH OF TABLE
- 1-1/2" STALLION EDGE ON FRONT AND REAR WITH SIDE EDGES 90 DEGREE BEND DOWN FOR TABLE LINE-UP
- STAINLESS STEEL BASE AND UNDERSHELF
- UNDERSHELF IS SECURED IN A FIXED POSITION, 10" ABOVE FLOOR
- SHIPPED STANDARD WELDED SET-UP
- NSF CERTIFIED



CONSTRUCTION:

- TOP: STAINLESS STEEL TOPS ARE TIG WELDED, EXPOSED WELDS ARE POLISHED TO MATCH ADJACENT SURFACE

MATERIAL:

- TOP: 16 GAUGE STAINLESSS STEEL TYPE 300 STAINLESS STEEL WITH #4 POLISH, SATIN FINISH
- SHELF: 18 GAUGE TYPE 300 STAINLESS STEEL, #4 POLISH WITH SATIN FINISH
- LEGS: 1-1/2" SQUARE O.D., 16 GAUGE TUBULAR STAINLESS STEEL
- PANELS: 20 GAUGE TYPE 300 STAINLESS STEEL, #4 POLISH WITH SATIN FINISH
- FEET: 1" ADJUSTABLE STAINLESS STEEL BULLET FEET

ENCLOSED BASE TABLES 16GA

24" WIDTH	QTY	30" WIDTH	QTY
EBHS6-2436		EBHS6-3036	
EBHS6-2448		EBHS6-3048	
EBHS6-2460		EBHS6-3060	
EBHS6-2472		EBHS6-3072	
EBHS6-2484		EBHS6-3084	
EBHS6-2496		EBHS6-3096	
EBHS6-24108		EBHS6-30108	
EBHS6-24120		EBHS6-30120	
EBHS6-24132		EBHS6-30132	
EBHS6-24144		EBHS6-30144	

DETAILED SPECIFICATIONS

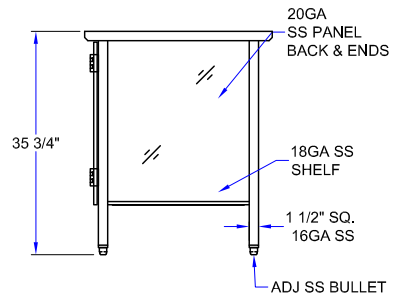
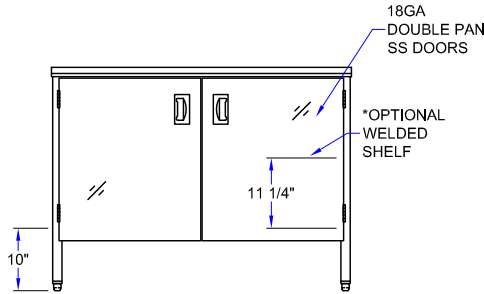
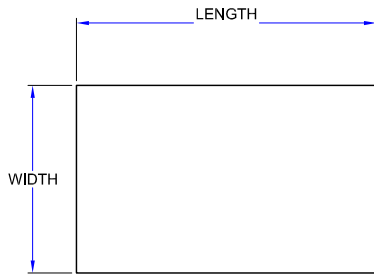

ENCLOSED BASE TABLES 16GA

LENGTH	LEGS	24" WIDTH	WEIGHT (LBS)	30" WIDTH	WEIGHT (LBS)
36"	4	EBHS6-2436	175	EBHS6-3036	185
48"	4	EBHS6-2448	202	EBHS6-3048	215
60"	4	EBHS6-2460	239	EBHS6-3060	250
72"	4	EBHS6-2472	247	EBHS6-3072	255
84"	6	EBHS6-2484	264	EBHS6-3084	275
96"	6	EBHS6-2496	280	EBHS6-3096	295
108"	6	EBHS6-24108	305	EBHS6-30108	320
120"	6	EBHS6-24120	330	EBHS6-30120	390
132"	6	EBHS6-24132	360	EBHS6-30132	375
144"	6	EBHS6-24144	405	EBHS6-30144	420

MODEL # STRUCTURE

S = STAINLESS 6 = GAUGE
 O = OPEN 24 = WIDTH - FRONT TO BACK
 EB = ENCLOSED BASE TABLE 36 = LENGTH - LEFT TO RIGHT

EBHS6-2436

SOME UNITS SHIP UNASSEMBLED FOR REDUCED SHIPPING COST. ALL DIMENSIONS ARE TYPICAL. TOLERANCE +/- .500"

John Boos & Co. is constantly engaged in a program of improving products and therefore reserves the right to change specifications without prior notice.



3601 S. Banker St. • Effingham, IL 62401 • PO BOX 609 • quotes@johnboos.com

112117



www.johnboos.com

735