

## Grandstand Mobile Buffet

### Model ST1780

Stainless Steel | 59"W x 27.5"D x 75.5"H

A full-service "standalone" portable buffet, capable of turning any venue party-ready within seconds, our Grandstand replaces endless tables and mountains of linens. You'll love how easily it wheels into position, and your guests will love the open, airy design that complements the visual food service.

### Features

- Standalone unit
- One-piece construction
- Heavy-duty stainless steel
- Locking casters
- Brushed finish
- Shelves easily click on and off
- Removable shelves offer a variety of setups
- Set includes 8 shelves:

- G3411W | 34"x 11" (2)
- G347W | 34"x 7" (2)
- G1811W | 18"x 11" (2)
- G187W | 18"x 7" (2)

### Add-Ons Available

- Wine rack
- Colored panel
- LED shelving
- Slotwall pack
- Lightcubes
- Protective dust cover



STURDY HOOKS LOCK REMOVABLE SHELF INTO PLACE



GRANDSTAND SIDE VIEW

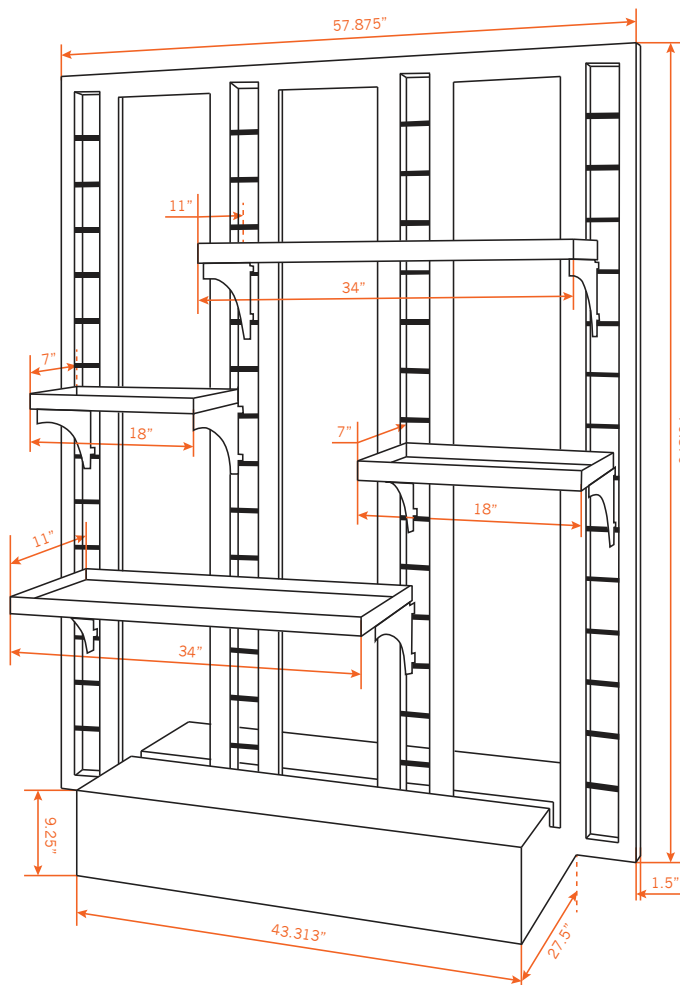

VIDEO AVAILABLE ONLINE 