



# Chef Tables - Stainless Steel Top with 5" Riser

## Stainless Steel Cabinet Base Tables with Hinged Doors

### Certifications:



### Features:

- 1 <sup>5/8</sup>" x 6" Straight S/S Leg
- 5" Riser
- Hinged Doors with or without Lock
- 96" Units have a Center Mullion with Two Sets of 48" Doors
- Legs Adjust 1" in Height
- Extra Supporting "C" Channels
- Casters Available



### Material:

- T-304 14 ga. Stainless Steel Top
- T-304 18 ga. Stainless Steel Body
- Stainless Steel Legs & Feet

### Options:

- Adjustable Shelf



### Single Sided:

Hinged Door	Unit Size (W x L x H)	Hinged Door + Lock	Unit Size (W x L x H)
CSTR5-3648H	36" x 48" x 39.75"	CSTR5-3648HL	36" x 48" x 39.75"
CSTR5-3660H	36" x 60" x 39.75"	CSTR5-3660HL	36" x 60" x 39.75"
CSTR5-3672H	36" x 72" x 39.75"	CSTR5-3672HL	36" x 72" x 39.75"
CSTR5-3696H*	36" x 96" x 39.75"	CSTR5-3696HL*	36" x 96" x 39.75"

\* Has a Center Mullion with Two Sets of 48" Doors

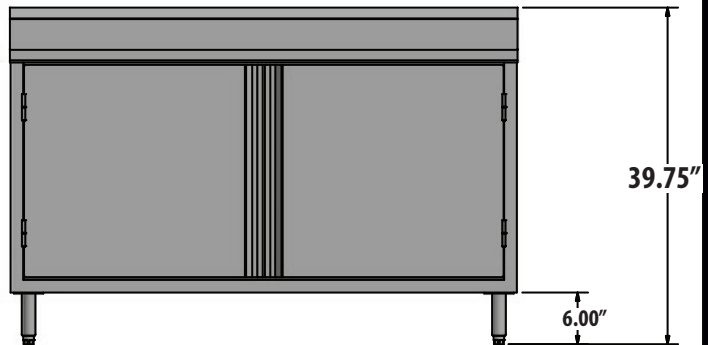
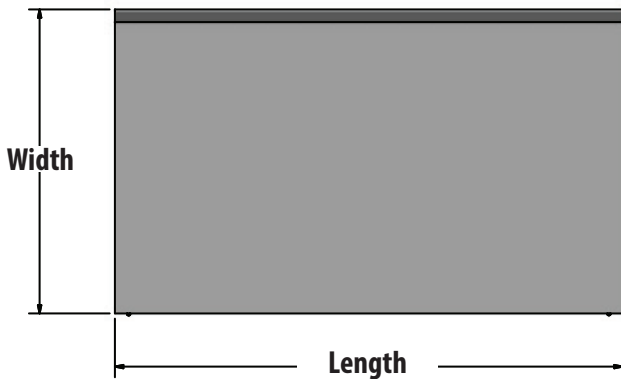

PRODUCT DATA SHEET

BK RESOURCES

