



Chef Tables - Stainless Steel Top with 4" Coved Riser

Stainless Steel Cabinet Base Tables with Hinged Doors & Lock

Certifications:



Features:

- 1 5/8" x 6" Straight S/S Leg
- 4" Coved Riser
- Hinged Doors with or without Lock
- 96" Units have a Center Mullion with Two Sets of 48" Doors
- Legs Adjust 1" in Height
- Extra Supporting "C" Channels
- Casters Available



Material:

- Hard Maple Bakers Top
- T-304 18 ga. Stainless Steel Body
- Stainless Steel Legs & Feet

Options:

- Adjustable Shelf



Single Sided:

Hinged Door	Unit Size (W x L x H)	Hinged Door + Lock	Unit Size (W x L x H)
CMBT-3648H	36" x 48" x 39"	CMBT-3648HL	36" x 48" x 39"
CMBT-3660H	36" x 60" x 39"	CMBT-3660HL	36" x 60" x 39"
CMBT-3672H	36" x 72" x 39"	CMBT-3672HL	36" x 72" x 39"
CMBT-3696H*	36" x 96" x 39"	CMBT-3696HL*	36" x 96" x 39"

* Has a Center Mullion with Two Sets of 48" Doors

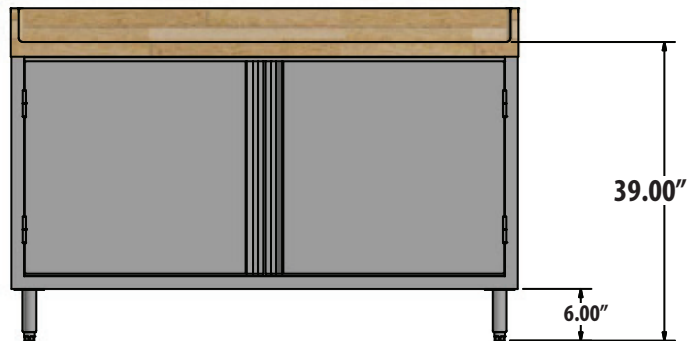
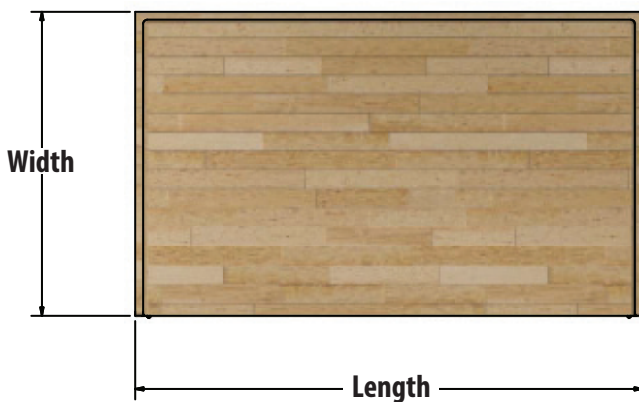

PRODUCT DATA SHEET

BK RESOURCES

