



BEVERAGE-AIR

| | |
|-----------------|------|
| Project: _____ | AIA# |
| Item: _____ | |
| Location: _____ | SIS# |
| Approved: _____ | |

FOOD PREPARATION SERIES

DPD93HC Deli/Pizza Prep Table with Two Doors and Two Drawers Hydrocarbon Series

MODEL:
DPD93HC-2

DPD93HC FOOD PREPARATION : DELI/PIZZA PREP SERIES

3 Year Parts/Labor Warranty
Additional 4 Year Compressor Warranty



CABINET CONSTRUCTION

- Stainless steel front, sides, top, door, drawers and grille (galvanized back & bottom)
- Interior liner is made of corrosion resistant aluminum
- Aluminum top interior liner prevents spill from falling into cabinet
- Stainless steel top
- Removable hoods and insulated lid assemblies are made of matching stainless steel
- Self-closing door with 120° stay-open feature on cam-lift hinges
- Magnetic gaskets provide positive seal on both door and drawers
- Field reversible door
- 3" Casters, 2 with brakes standard
- 19" Wide reversible cutting board is removable for easy cleaning
- Two (2) epoxy-coated steel wire shelves per door section
- Units will accept pans up to 6" deep (pans are not included)
- Drawer frames are heavy-duty stainless steel
- 12-Gauge stainless steel drawer slides with Delrin® rollers rated at 275 lbs
- Telescoping slides, with locking mechanism to prevent drawers from being pulled off of cabinet
- Heavy-duty pan locking divider supports are standard in drawers
- Compressor available on left or right, specify at time of unit order

OPTIONS & ACCESSORIES

- Stainless steel back
- Stainless steel interior
- Clear-lid models
- Overshelf kits
- Additional shelves
- Shelf clips
- Pan support
- 6" Legs black or seismic/flanged
- Door locks
- Composite cutting board
- Thermometer
- Night cover
- Bun tray rack
- Remote option* (see note on back page)

REFRIGERATION SYSTEM

- Uses environmentally friendly, energy efficient R290 refrigerant, and meets all regulatory requirements for CARB, SNAP, DOE & more
- Adaptive defrost
- Epoxy coated evaporator coil
- Raised rail maintains temperatures between 36° - 38°F



Please verify qualifying units by visiting:
www.energystar.gov/cfs

3779 Champion Blvd., Winston-Salem, NC 27105
1-888-845-9800 Fax: 1-336-245-6453
Beverage-Air.com Sales@bevair.com



BEVERAGE-AIR

| MODEL | DPD93HC-2 |
|----------------------------------|-----------------------|
| EXTERNAL DIMENSIONAL DATA | |
| Width Overall | 93" |
| Depth Overall with Cutting Board | 37" |
| Height Overall with Casters | 53 1/8" |
| Number of Drawers | 2 |
| Depth with Drawer Extended | 55 3/8" |
| Drawer Opening | (2) 21 5/8" x 10 3/4" |
| Number of Doors | 2 |
| Cutting Board | 19" |
| INTERNAL DIMENSIONAL DATA | |
| NET Capacity (cubic ft.) | 31.5 |
| Internal Width Overall (in) | 74" |
| Internal Depth Overall (in) | 26" |
| Internal Height Usable (in) | 23 1/8" |
| No. of Shelves | 4 |
| ELECTRICAL DATA | |
| Full Load Amperes | 7.8 |
| REFRIGERATION DATA | |
| Horsepower | 1/2 |
| Capacity (BTU/Hr) | 4234 |
| SHIPPING DATA | |
| Gross Weight - Crated | 632 lbs |
| Height - Crated | 46" |
| Width - Crated | 96" |
| Depth - Crated | 36" |

*NOTE: Remote units are field wired and come with 6" legs. Refrigerant must be specified at time of order.

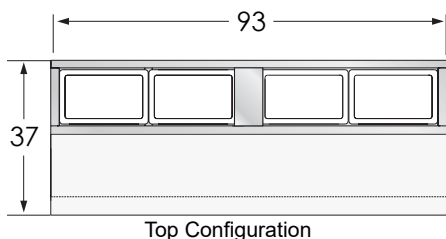

Deli/Pizza Preparation Table

Model: DPD93HC-2

Model Views

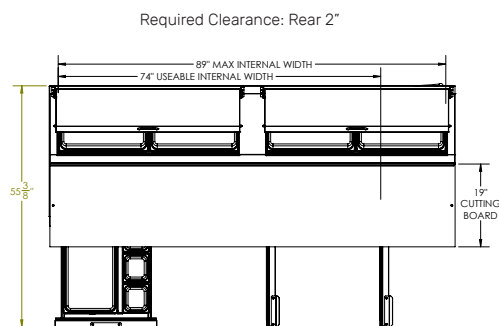

PLAN VIEW

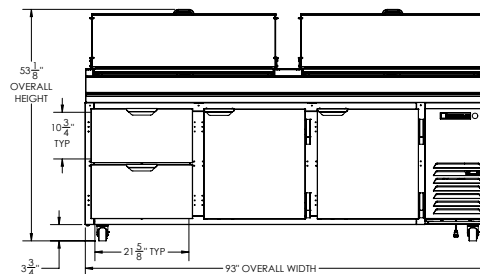

ELEVATION VIEW

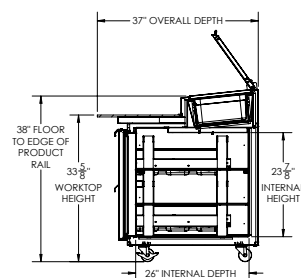

SIDE VIEW

*ELECTRICAL CONNECTION



115/60/1
NEMA 5-15P

Unit pre-wired at factory and include 8' long cord and plug set.



3779 Champion Blvd., Winston-Salem, NC 27105 1-888-845-9800 Fax: 1-336-245-6453 Beverage-Air.com Sales@bevair.com

an Ali Group Company



The Spirit of Excellence