



BEVERAGE-AIR

| | |
|-----------------|------|
| Project: _____ | AIA# |
| Item: _____ | |
| Location: _____ | SIS# |
| Approved: _____ | |

BF602DP BLAST CHILLER/SHOCK ROLL-IN FREEZER

BLAST CHILLER

BF602DP Solid Door Blast Chiller

MODEL:
BF602DP-1P



3 Year Parts/Labor Warranty
Additional 2 Year Compressor Warranty

CABINET CONSTRUCTION

- Stainless steel exterior and interior
- Die-formed interior floor has rounded corners
- Central drain for easy cleaning
- Anti-condensation perimeter heating around door opening
- Ergonomic door handle and stainless steel
- Snap in place magnetic gaskets self closing door with hold open stop at 100°
- Soft and hard, timed or core probe blast chilling
- Soft and hard, timed or core probe shock freezing
- Automatic recognition of core probe
- Multi point sensor temperature display button
- Core probe heater button
- HACCP alarm display button
- Pre-cooling cycle button
- Adjustable evaporator fan speed button
- Timed manual defrost button
- USB data recorder
- Infinity mode program with adjustable set point
- Automatic conservation mode at end of cycle
- On board recipe book with 68 pre-set programs
- 99 Free memory positions for custom programs
- LCD illuminated temperature display
- Real time clock
- One, high precision heated multi sensor probe
- Maximum interior dimensions for carts: 30.7"W x 122.8"D x 75.5"H

OPTIONS & ACCESSORIES

- UV sterilization lamp (must be added at time of order)
- Single sensor probes (up to 4 possible)
- Change door swing
- Rs 485 connection for external monitoring system

REFRIGERATION SYSTEM

- Refrigeration system uses R404 refrigerant
- Evaporator fitted with a high flow rate fan insures maximum cooling efficiency
- Indirect air flow assures highest product quality
- Manual defrosting with door open on a timed cycle
- Blast chilling (194°F to 37°F in 90 minutes) or shock freezing (194°F to 0°F in 240 minutes) cycles



Please verify qualifying units by visiting:
www.energystar.gov/cfs

3779 Champion Blvd., Winston-Salem, NC 27105
1-888-845-9800 Fax: 1-336-245-6453
Beverage-Air.com Sales@bevair.com



BEVERAGE-AIR®

| MODEL | BF602DP-1P |
|------------------------------------|--------------|
| EXTERNAL DIMENSIONAL DATA | |
| Width Overall | 59.06" |
| Depth Overall | 132.87" |
| Height Overall | 87.80" |
| Number of Doors | 1 |
| Width, Door Opening (in) | 203.15" |
| PERFORMANCE DATA | |
| Sheet Pan Capacity (18"X26") | 60 |
| Steam Table Pan Capacity (12"X20") | 120 |
| Chilling Capacity In 90 Min | 1000 lbs |
| Freezing Capacity In 240 Min | 665 lbs |
| Climate Class | 5 |
| Capacity Mobile Cart(s) | 3 GN 2/1 |
| ELECTRICAL DATA | |
| Cabinet Voltage | 208-240/60/3 |
| Total Amperes | 26 |
| NEMA Plug | N/A |
| REFRIGERATION DATA | |
| Condensing Unit Size, HP | N/A |
| Refrigerant | R404 |
| Capacity (BTU/HR) (113°F/14°F) | 75,491 |
| WEIGHT DATA | |
| Gross Weight - Crated | 2828 lbs |
| Height - Crated | (3) 91" |
| Width - Crated | (3) 55" |
| Depth - Crated | (3) 72" |

Blast Chiller/Shock Roll-In Freezer Model: BF602DP-1P

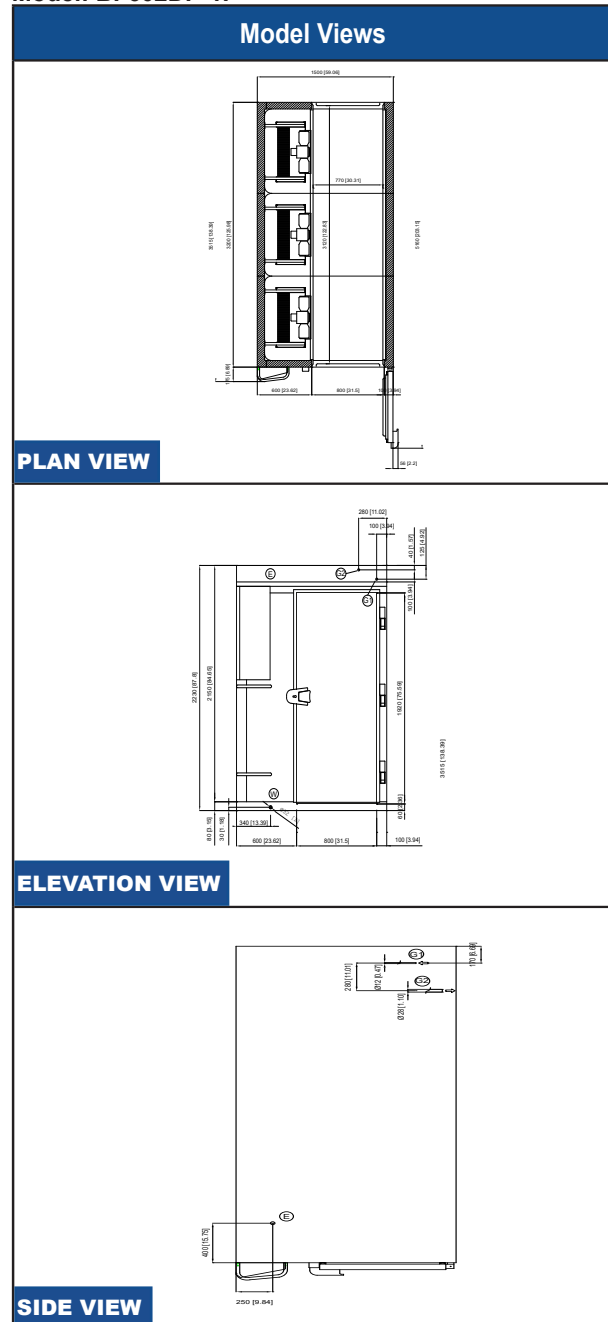

an Ali Group Company



The Spirit of Excellence

3779 Champion Blvd., Winston-Salem, NC 27105
1-888-845-9800 Fax: 1-336-245-6453
Beverage-Air.com Sales@bevalr.com