



BEVERAGE-AIR

Project: _____	AIA#
Item: _____	
Location: _____	SIS#
Approved: _____	

BLAST CHILLER

BF202DP Solid Door Blast Chiller

MODEL:
BF202DP-1P

BF202DP BLAST CHILLER/SHOCK ROLL-IN FREEZER

3 Year Parts/Labor Warranty
Additional 2 Year Compressor Warranty

CABINET CONSTRUCTION

- Stainless steel exterior and interior
- Die-formed interior floor has rounded corners
- Central drain for easy cleaning
- Anti-condensation perimeter heating around door opening
- Ergonomic door handle and stainless steel
- Snap in place magnetic gaskets self closing door with hold open stop at 100°
- Soft and hard, timed or core probe blast chilling
- Soft and hard, timed or core probe shock freezing
- Automatic recognition of core probe
- Multi point sensor temperature display button
- Core probe heater button
- HACCP alarm display button
- Pre-cooling cycle button
- Adjustable evaporator fan speed button
- Timed manual defrost button
- USB data recorder
- Infinity mode program with adjustable set point
- Automatic conservation mode at end of cycle
- On board recipe book with 68 pre-set programs
- 99 Free memory positions for custom programs
- LCD illuminated temperature display
- Real time clock
- One, high precision heated multi sensor probe
- Maximum interior dimensions for carts: 44"W x 30.7"D x 75.5"H

OPTIONS & ACCESSORIES

- UV sterilization lamp (must be added at time of order)
- Single sensor probes (up to 4 possible)
- Change door swing
- Rs 485 connection for external monitoring system

REFRIGERATION SYSTEM

- Refrigeration system uses R404 refrigerant
- Evaporator fitted with a high flow rate fan insures maximum cooling efficiency
- Indirect air flow assures highest product quality.
- Manual defrosting with door open on a timed cycle
- Blast chilling (194°F to 37°F in 90 minutes) or shock freezing (194°F to 0°F in 240 minutes) cycles



Please verify qualifying units by visiting:
www.energystar.gov/cfs

3779 Champion Blvd., Winston-Salem, NC 27105
1-888-845-9800 Fax: 1-336-245-6453
Beverage-Air.com Sales@bevair.com



BEVERAGE-AIR®

MODEL	BF202DP-1P
EXTERNAL DIMENSIONAL DATA	
Width Overall	59.06"
Depth Overall	54.13"
Height Overall	87.80"
Number of Doors	1
Width, Door Opening (in)	85.83"
PERFORMANCE DATA	
Sheet Pan Capacity (18"X26")	20
Steam Table Pan Capacity (12"X20")	40
Chilling Capacity In 90 Min	350 lbs
Freezing Capacity In 240 Min	230 lbs
Climate Class	5
Capacity Mobile Cart(s)	1 GN 2/1
ELECTRICAL DATA	
Cabinet Voltage	208-240/60/3
Total Amperes	9
NEMA Plug	N/A
REFRIGERATION DATA	
Condensing Unit Size, HP	N/A
Refrigerant	R404
Capacity (BTU/HR) (113°F/14°F)	41,599
WEIGHT DATA	
Gross Weight - Crated	1030 lbs
Height - Crated	89"
Width - Crated	55"
Depth - Crated	70"

Blast Chiller/Shock Roll-In Freezer Model: BF202DP-1P

Model Views

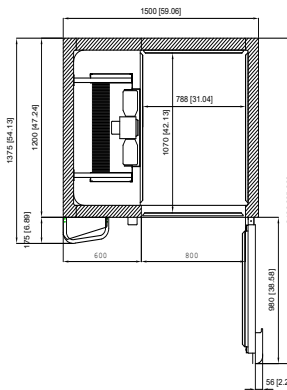

PLAN VIEW

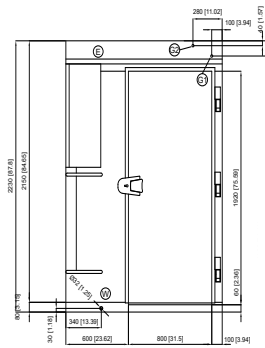

ELEVATION VIEW

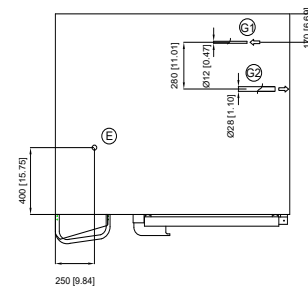

SIDE VIEW



an Ali Group Company



The Spirit of Excellence

3779 Champion Blvd., Winston-Salem, NC 27105
1-888-845-9800 Fax: 1-336-245-6453
Beverage-Air.com Sales@bevaair.com